

BUCHAS DE ESFERAS - SUPER, AUTO-ALINHÁVEL / AJUSTÁVEL

ALTA CAPACIDADE DE CARGA (3x convencional)
VIDA ÚTIL MAIOR

Por ser auto alinhável:
Requer 2 rolamentos em, pelo menos, 1 dos eixos.

MOVIMENTAÇÃO EXTREMAMENTE SUAVE



LMES...UU



LMES...UUOP

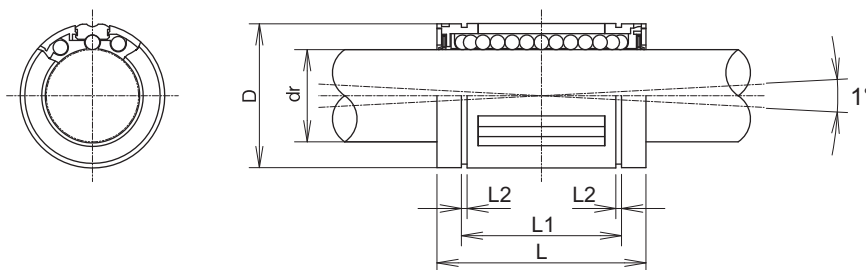

LMES12-OP

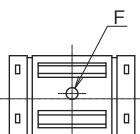
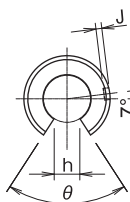

LMES16-OP, LMES20-OP

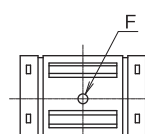
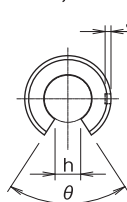

LMES25-OP

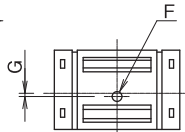
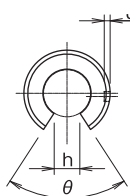

LMES30-OP, LMES40-OP, LMES50-OP

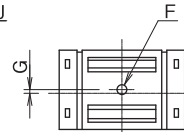
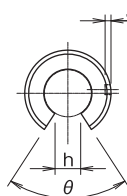

| MODELO STANDARD | N° de circuitos | Massa (g) | dr | | D | L | | L1 | | L2 | Capacidade Carga | |
|-----------------|-----------------|-----------|-----------------|------|----|-----------------|-------|-----------------|-------|------|------------------|-----------------|
| | | | Tolerância (µm) | | | Tolerância (mm) | | Tolerância (mm) | | | Dinâmica C (N) | Estática Co (N) |
| LMES 10UU | 5 | 17 | 10 | + 8 | 19 | 29 | ± 0.2 | 21.7 | ± 0.2 | 1.35 | 750 | 550 |
| LMES 12UU | 5 | 23 | 12 | 0 | 22 | 32 | | 22.7 | | 1.35 | 1230 | 1100 |
| LMES 16UU | 5 | 28 | 16 | + 9 | 26 | 36 | | 24.7 | | 1.35 | 1550 | 1250 |
| LMES 20UU | 6 | 61 | 20 | 1 | 32 | 45 | | 31.3 | | 1.65 | 2580 | 1670 |
| LMES 25UU | 6 | 122 | 25 | + 11 | 40 | 58 | | 43.8 | | 1.90 | 3800 | 2750 |
| LMES 30UU | 6 | 185 | 30 | 1 | 47 | 68 | | 51.8 | | 1.90 | 4710 | 2800 |
| LMES 40UU | 6 | 360 | 40 | + 13 | 62 | 80 | | 60.4 | | 2.20 | 6500 | 5720 |
| LMES 50UU | 6 | 580 | 50 | 2 | 75 | 100 | | 77.4 | | 2.70 | 11460 | 7940 |

| MODELO STANDARD | N° de circuitos | Massa (g) | dr | D | L | | L2 | h | ? | F | G | J | Capacidade Carga | |
|-----------------|-----------------|-----------|----|----|-----------------|-------|------|------|-----|-----|-----|-----|------------------|-----------------|
| | | | | | Tolerância (mm) | | | | | | | | Dinâmica C (N) | Estática Co (N) |
| LMES 12UUOP | 4 | 18 | 12 | 22 | 32 | ± 0.2 | 1.35 | 6.5 | 66° | 3.0 | - | 0.7 | 1290 | 1260 |
| LMES 16UUOP | 4 | 22 | 16 | 26 | 36 | | 1.35 | 9 | 68° | | - | 0.7 | 1640 | 1320 |
| LMES 20UUOP | 5 | 51 | 20 | 32 | 45 | | 1.65 | 9 | 55° | | - | 0.9 | 2630 | 1720 |
| LMES 25UUOP | 5 | 102 | 25 | 40 | 58 | | 1.90 | 11.5 | 57° | | 1.5 | 1.4 | 3910 | 2850 |
| LMES 30UUOP | 5 | 155 | 30 | 47 | 68 | | 1.90 | 14 | 57° | | 2.0 | 2.2 | 4850 | 2900 |
| LMES 40UUOP | 5 | 300 | 40 | 62 | 80 | | 2.20 | 19.5 | 56° | | 1.5 | 2.3 | 6700 | 5900 |
| LMES 50UUOP | 5 | 480 | 50 | 75 | 100 | | 2.70 | 22.5 | 54° | | 2.5 | 2.7 | 11700 | 8100 |

